

## CAPE COD SHELTER INSTALLATION INSTRUCTIONS



### **Before You Begin:**

- **Consult your local building department for any required permits**  
You may be required to obtain a building permit for this structure. Contact your local building department for details.
- **Read instructions thoroughly**  
Please read all instructions and notes carefully prior to assembly.
- **Check for all parts**  
Use the Parts and Hardware List to identify all parts. To prevent scratching of painted materials, place on a tarp or other protective material.
- **Prepare surrounding area**  
Remove any obstructions around shelter location. Shelter installation should be scheduled after all concrete and masonry work in the surrounding area is completed.
- **Assistance is required during entire assembly.**



### **CAUTION**

- Proper site preparation is required.
- Standard shade structure design does not include additional loads such as hanging heavy plants, swings, or other objects.
- DO NOT stand or sit on the shade structure roof.
- Repair or replace broken parts immediately.
- This kit contains parts with metal edges. Please be careful when handling.

## Tools Needed for Installation

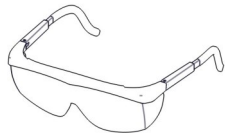

Safety Glasses

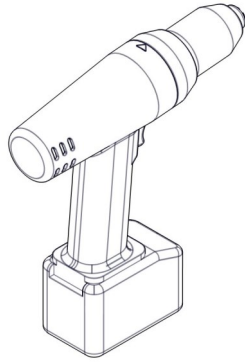

Electric Drill

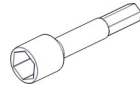

Socket / Hex Head Driver  
Sizes: 1/4", 5/16", 3/4",  
1", 1-1/16"

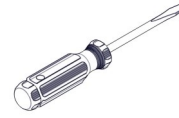

Screw Driver  
Flat & Phillips

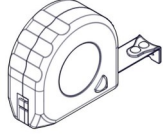

Tape Measure



Socket / Ratchet Wrench  
Sizes: 1/4", 5/16", 3/4",  
1", 1-1/16"

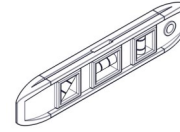

Carpenters Level



Ladder

Other Required Tools: Gloves, Chalk Line, Silicone Caulking

Recommended Tools: Rubber Mallet, Carpenters Square, Pliers, Metal Hack Saw

NOTE: Heavier equipment such as a forklift, boom lift, or lift table may also be required.

## Installation Notes and Tips

- Complete site preparation before beginning assembly.
- It is VERY IMPORTANT that the current footing layout is obtained from the manufacturer before pouring any footings or setting any anchor bolts.
- Anchor bolts are NOT included and must be furnished at the time of installation. Consult local building codes and the provided manufacturer's drawing for required anchor specifications.
  - We recommend using high quality stainless steel anchor bolts in areas with a corrosive climate.
- If the shelter is set on a concrete slab, the slab must be level so that all posts will be at the same elevation when mounted and anchored down.
  - If the shelter is set on an unlevel surface, it will bolt together if assembled with all bolts loose. When the bolts are tightened, some of the steel joints may have gaps and the unit may not be exactly plumb. However, the strength of the structure will not be affected.
- In areas with frequent rain, the slab or footing elevation should be at least 1" above the elevation of the surrounding landscape to prevent water from ponding around the base plate and anchor bolts.
- DO NOT attempt to assemble on a day with strong winds.
- Have assistance nearby to lift and secure parts in place.
- As is common in the erection of all types of metal structures, due to job site conditions (uneven slabs, footings, etc.), slight modifications such as reaming of some holes or drilling new holes may become necessary and must be done on the job site.
- Predrilling holes and removing metal shavings and debris from between components before fastening together will help prevent rusting or staining of the surrounding surfaces.
- Cutting and drilling metal components will cause shavings which must be carefully removed by sweeping or brushing. If this is not done, the metal shavings will rust and stain the surface finish.
- It is recommended to lower the speed of electric drills during this installation. Installing Tek screws at a high RPM may cause the Tek screws to become damaged or break during installation.

## Installation Notes and Tips (continued)

- Avoid over-driving, under-driving, or driving at an angle to properly install fasteners. Over-driven fasteners can depress the material and allow water to collect around the fastener, which will corrode the surface finish. Under-driven fasteners can cause leaks and may back out over time.

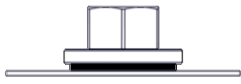

✓ CORRECT



✗ TOO LOOSE



✗ TOO TIGHT

- The center-to-center spacing of the roof panel locks must be maintained as the panels are installed. If this is not done, problems may not show up until towards the end of the installation when parts may appear to be cut too short or too long. If this happens, check each roof panel spacing and re-set if necessary.
- We strongly recommend using a high grade sealant, such as our 100% silicone caulk and sealant. Caulking should be applied uniformly and without skips. A poor caulking job can cause leaks.

## Care and Maintenance

Every 12 months your shade structure should be inspected and maintained by:

- Tightening loose nuts and bolts at all connections.
- Repairing damage to the finish to prevent corrosion.
- Replacing lost or damaged fasteners, brackets, and other parts.
- Replacing brittle or cracked sealer to prevent leaks.
- Removing obstructions and miscellaneous build-up from gutters, eaves, and downspouts.

**Note:** *These are basic installation guidelines for our standard load units and may not be suitable to your specific installation. It is important to follow all local and national building codes when installing any exterior improvement product.*

NOTE: Length and quantity of parts will vary based on the size of the shelter.

## Parts List

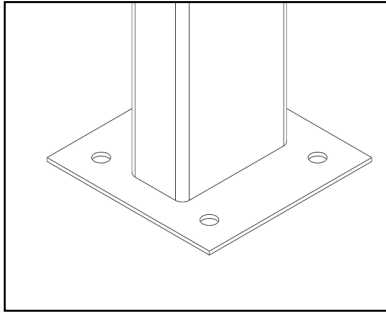

**A** Steel Post

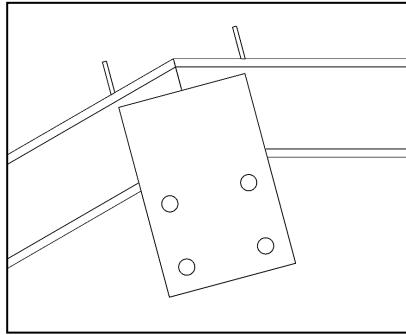

**B** Steel Rafter

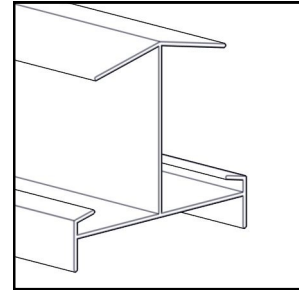

**C** Ridge Cap  
Part Code: 11517

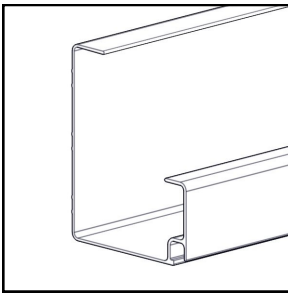

**D** Gutter  
Part Code: 11139

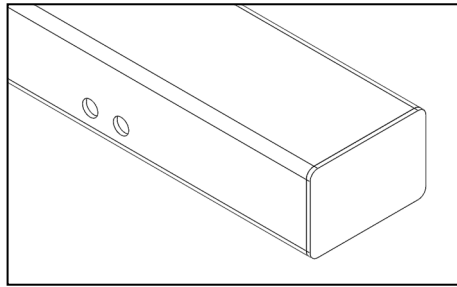

**E** Ridge Beam

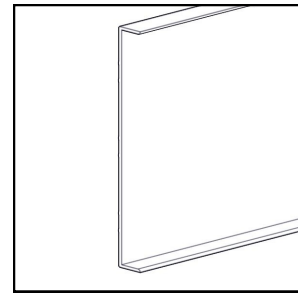

**F** Projection Fascia

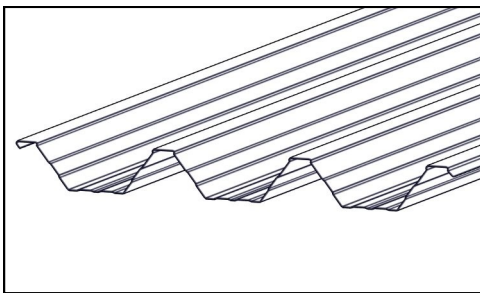

**G** Roof Panel W Style  
Aluminum Part Code: 10307  
Galvalume Part Code: 30106

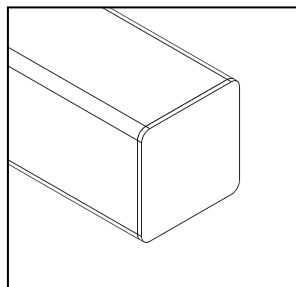

**H** Edge Beam

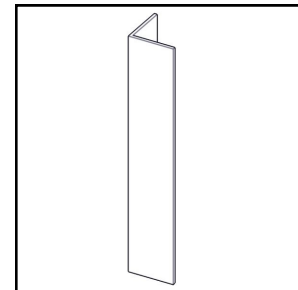

**I** Corner Cap  
Part Code: 60048

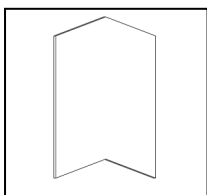

**J** Peak Cap

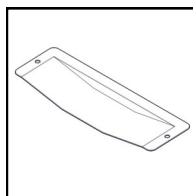

**K** Scupper  
Part Code: 90241

Screws shown actual size.

## Hardware List

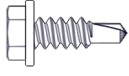

**AA** #8 x 1/2" Screw  
Part Code: 20102

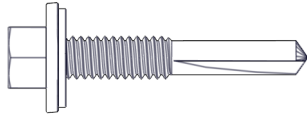

**BB** #12 x 1-1/4" Screw  
Part Code: 20201

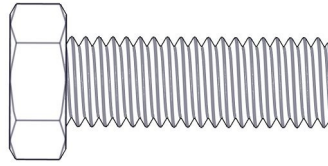

**CC** 1/2" Hex Bolt  
Length Varies

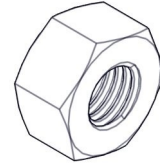

**DD** 1/2" Hex Nut  
Part Code: 20530

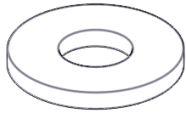

**EE** 1/2" Washer  
Part Code: 20910

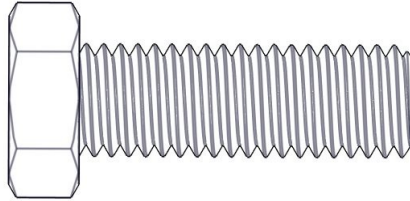

**FF** 5/8" Hex Bolt  
Length Varies

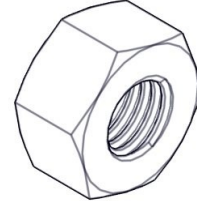

**GG** 5/8" Hex Nut  
Part Code: 20531

NOTE: Bolt diameter and length determined by factors such as loading requirements, plate thicknesses, etc. Always check the provided manufacturer's drawing for bolt specifications required at each connection point.

## OPTIONAL Parts

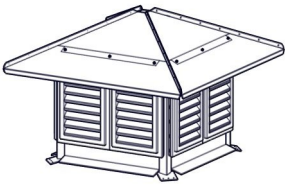

**L** Cupola (shown with optional louvers)

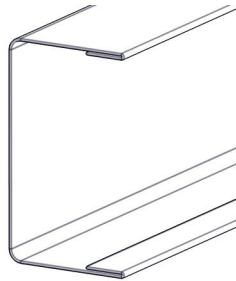

**M** Cupola Flashing

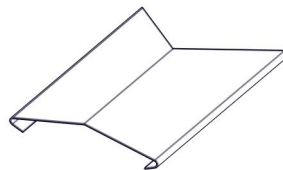

**N** Ridge Cap Flashing

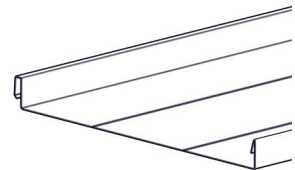

**O** 18" Wide Standing Seam Panel  
Part Code: 30120

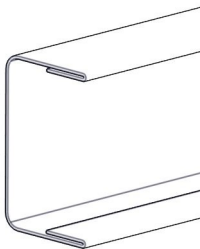

**P** Wood Roof C Cap

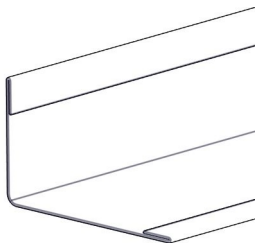

**Q** SS Panel C Cap



**R** Wood Roof V Flashing



**S** Drip Edge Flashing

## OPTIONAL Parts (continued)

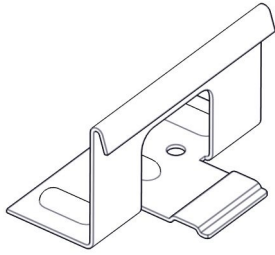

**T** SS Panel Clip  
Part Code: 20836

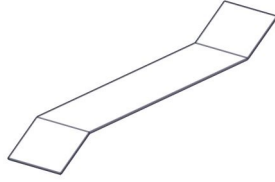

**U** Gutter Strap

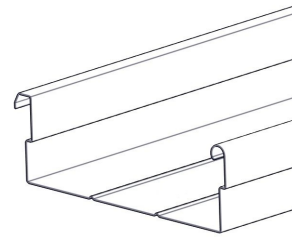

**V** 8" Wide Standing  
Seam Panel  
Part Code: 10214

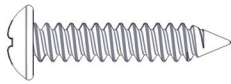

**HH** #10 x 1" Screw  
Part Code: 20650

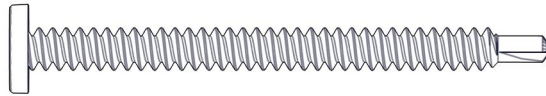

**||** #14 x 2-3/4" Screw  
Part Code: 20663

*NOTE: All required concrete work must be completed and anchor bolts set prior to beginning this installation. (surface mounted units only)*

### STEP 1

Layout all posts **(A)** and rafters **(B)**. Attach using (4) 1/2" hex bolts **(CC)** and 1/2" hex nuts **(DD)** at each assembly.

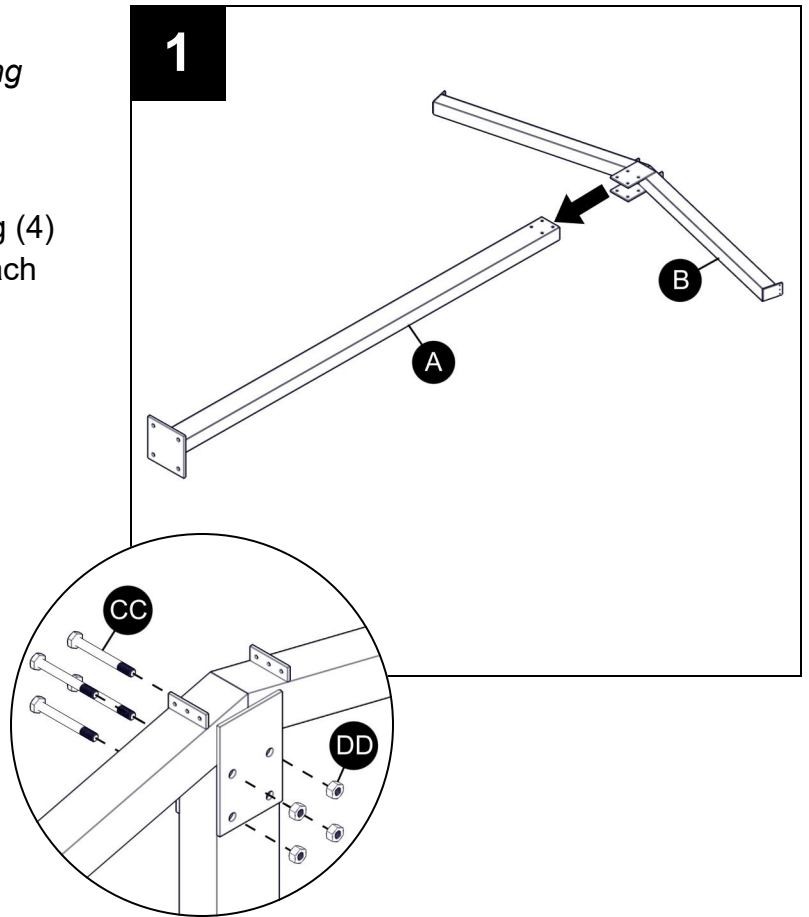

### STEP 2

Stand up the post/rafter assembly and set into footing holes. Set to the required elevation as shown on the provided drawings, then plumb and brace. Fill footing with concrete and allow to completely harden before continuing installation.

If installing posts surface mounted, set post/rafter assembly over anchor bolts. Attach the anchor bolt nuts and washers, but DO NOT completely tighten at this time.

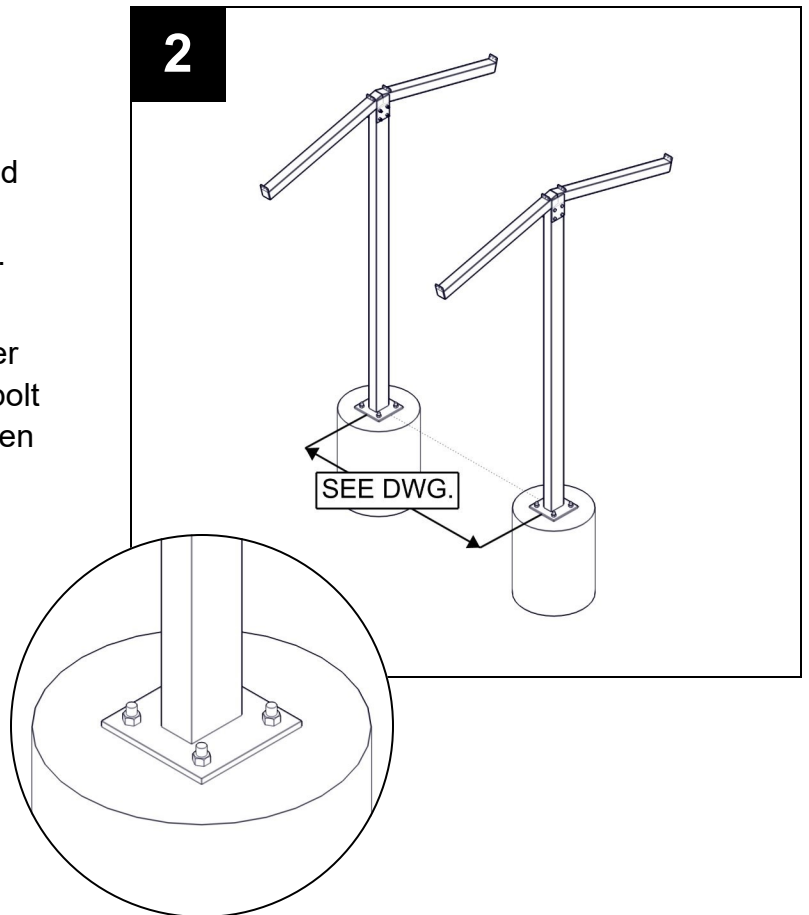

## OPTIONAL - Ridge Beam Installation

Position ridge beam (**E**) centered on rafters (**B**) and between the mounting plates. Be sure to leave equal overhang on both ends.

Attach the ridge beam using (2) 1/2" x 7-1/2" hex bolts (**CC**) and 1/2" hex nuts (**DD**) at each connection.

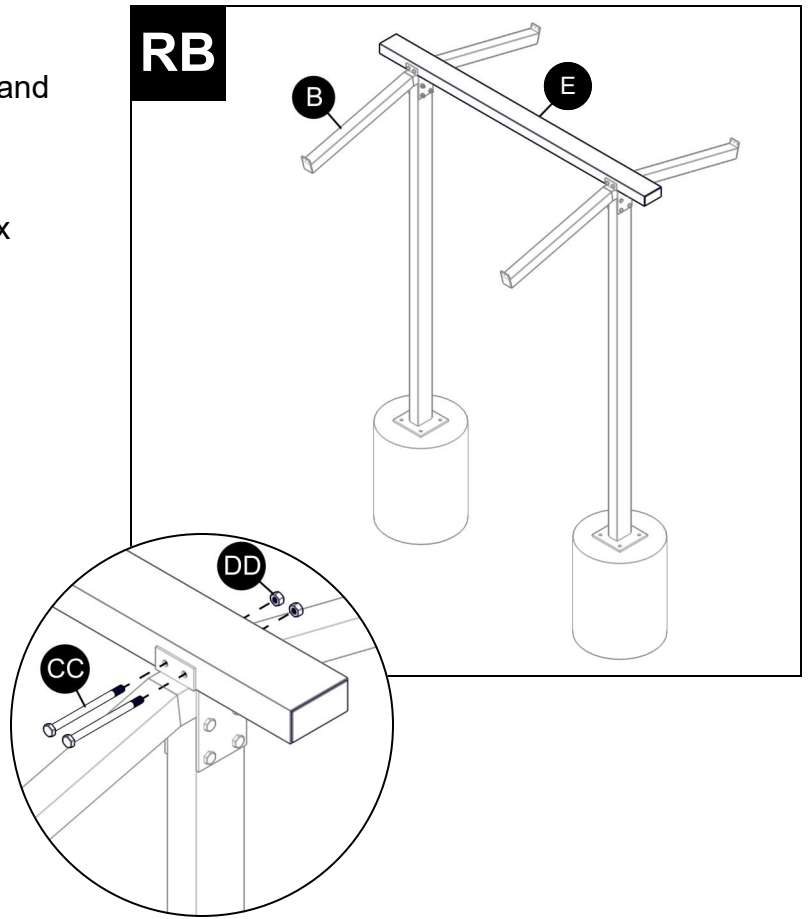

To attach ridge cap (**C**), position centered over ridge beam (**E**). Attach using #12 x 1-1/4" screws (**BB**) at 12" on center.

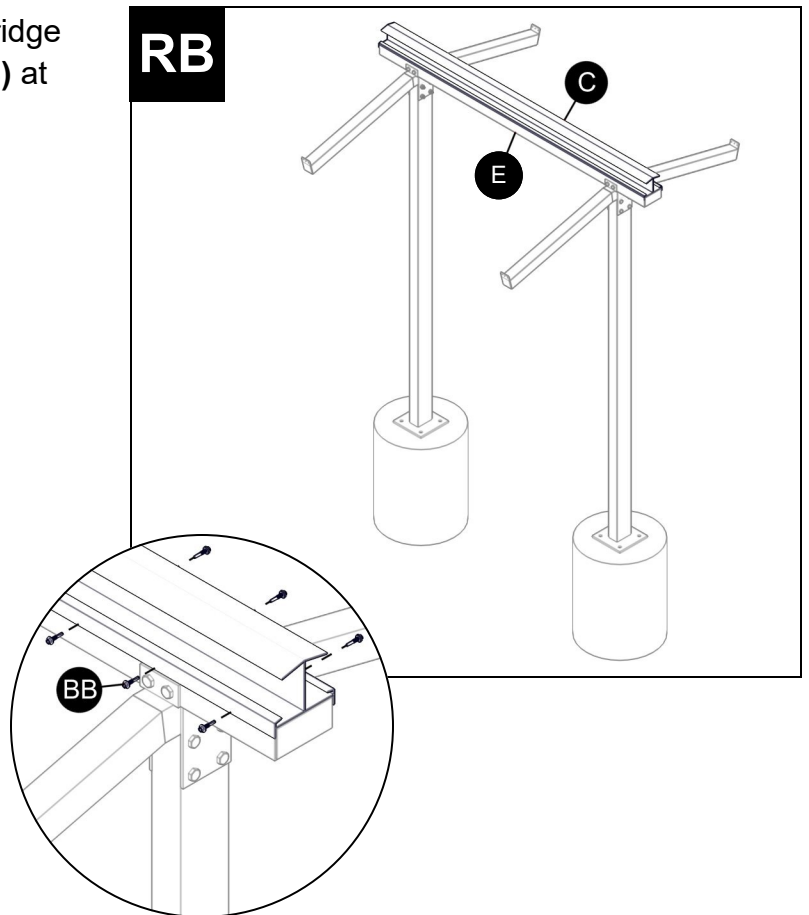



### OPTIONAL - Edge Beam Installation

Position edge beam (**H**) on top of rafters (**B**) and against the mounting plate at the end of the rafters. Be sure to leave equal overhang on both ends.

Attach the edge beam using (3) #12 x 1-1/4" screws (**BB**) at each connection.

Repeat for opposite side.

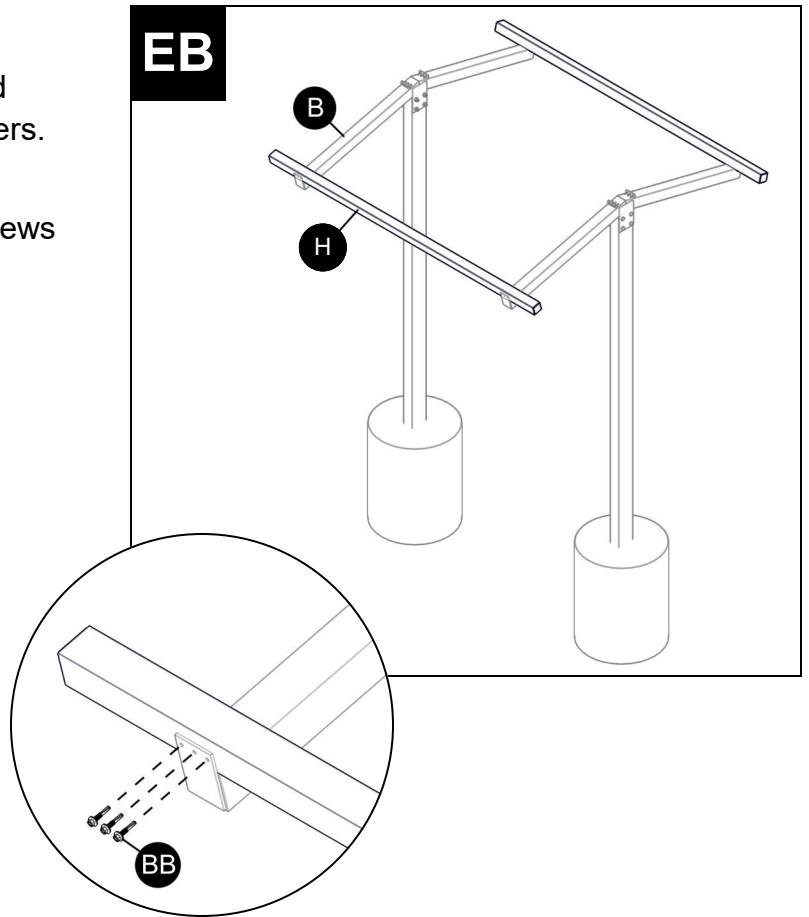

Begin roof panel (**G**) installation with the side of the first panel approximately 1" from the end of edge beam (**H**). Attach to edge beam using #12 x 1-1/4" screws (**BB**) at 8" on center.

Continue attaching roof panels as shown in Step 7. Attach gutter (**D**) to roof panels (**G**) using (2) #8 x 1/2" screws (**AA**) at 8" on center.

Continue installation with Step 8.

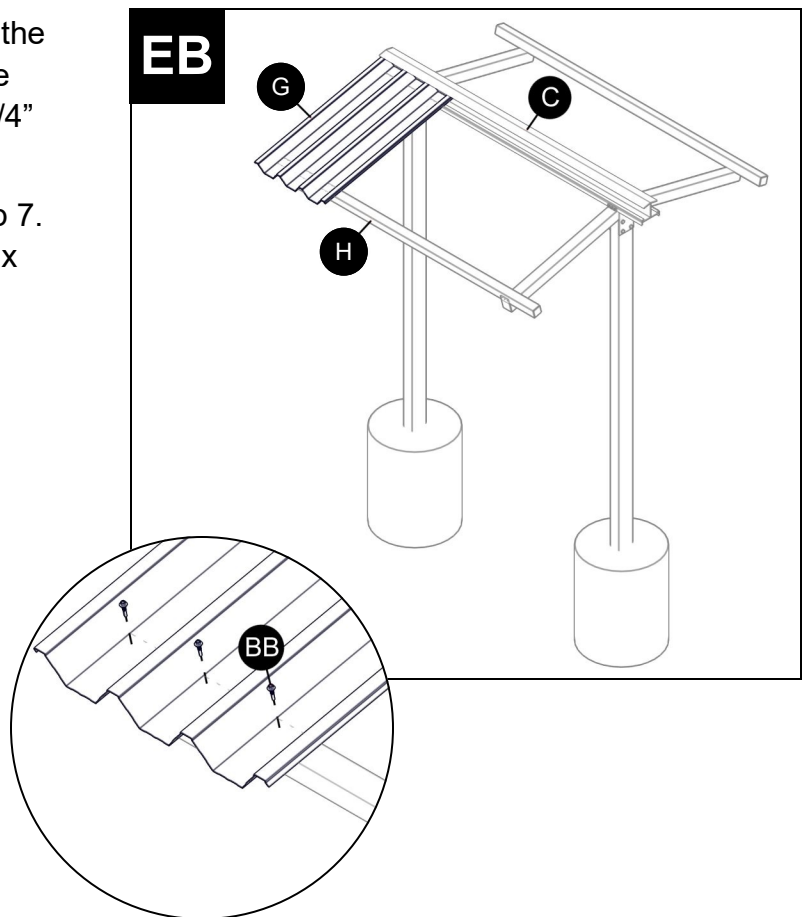

### STEP 3

Position ridge cap (**C**) centered on rafters (**B**) and between the mounting plates. Be sure to leave equal overhang on both ends.

Attach the ridge cap using (3) #12 x 1-1/4" screws (**BB**) at each connection.

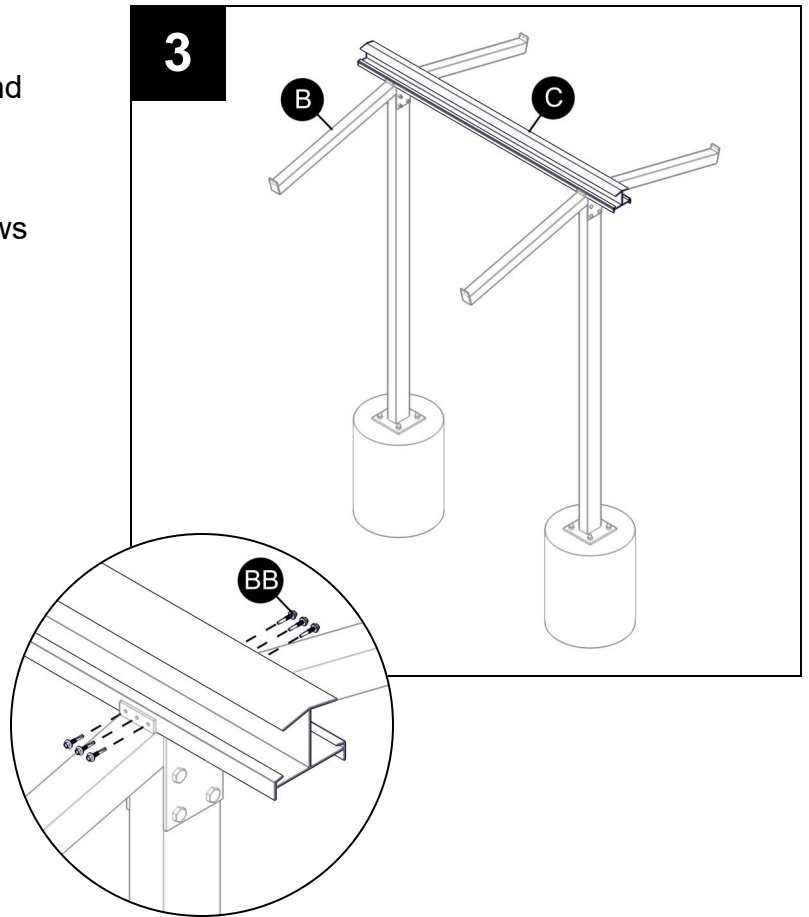

### STEP 4

Position gutter (**D**) on top of rafters (**B**) and against the mounting plate at the end of the rafters. Be sure to leave equal overhang on both ends.

Attach the gutter using (3) #12 x 1-1/4" screws (**BB**) at each connection.

Repeat for opposite side.

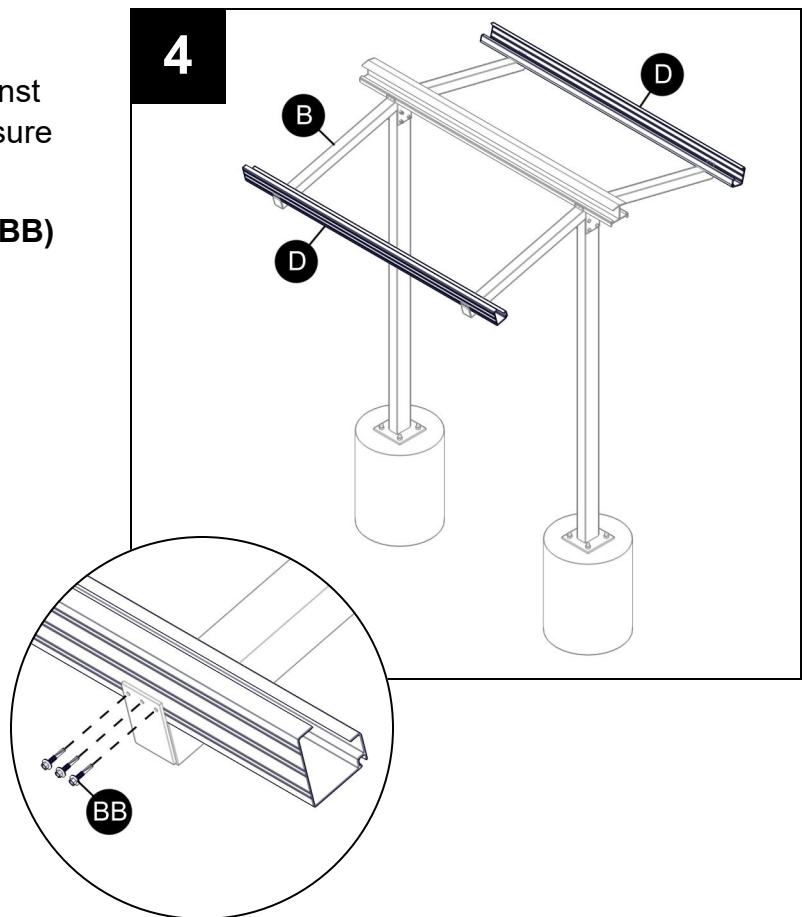

## STEP 5

Position projection fascia (**F**) at either end of the structure. Plumb the straight end with the front of gutter (**D**).

Attach the top flange of projection fascia (**F**) to ridge cap (**C**) using #8 x 1/2" screw (**AA**).

Attach fascia to gutter (**D**) by caulking and installing corner cap (**I**) using (4) #8 x 1/2" screws (**AA**).

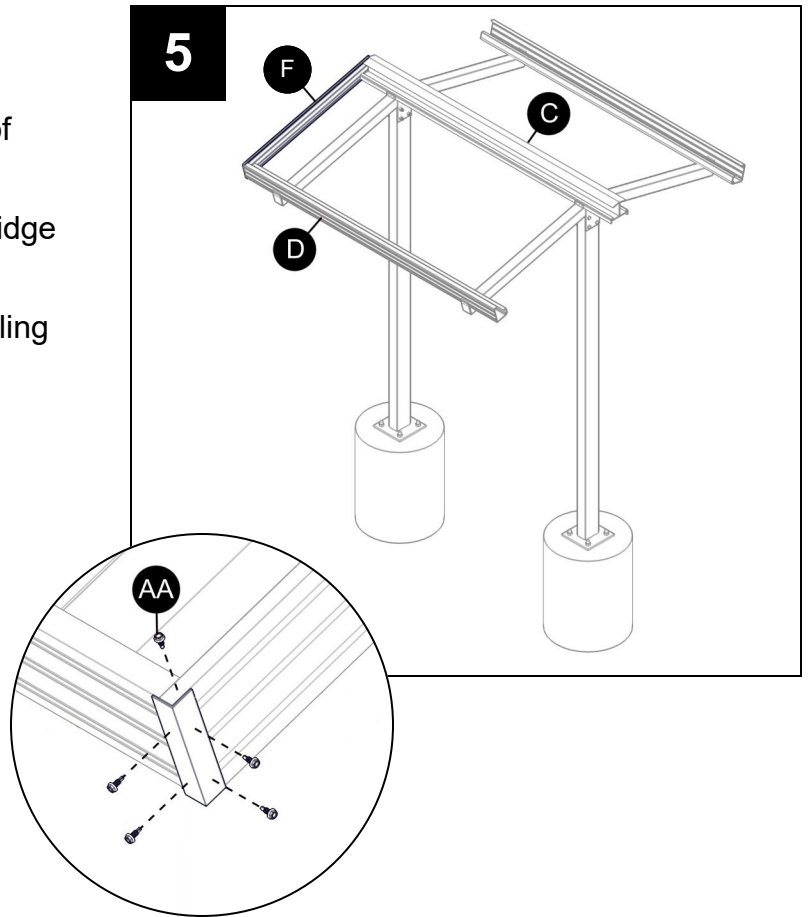

## STEP 6

Begin roof panel (**G**) installation by positioning one panel between ridge cap (**C**) and gutter (**D**), and against projection fascia (**F**).

Attach the panel to ridge cap (**C**) and gutter (**D**) using #8 x 1/2" screws (**AA**) at 8" on center, (1) at each valley of the panel. Also attach the ribs of the panel to gutter (**D**) using #8 x 1/2" screws (**AA**).

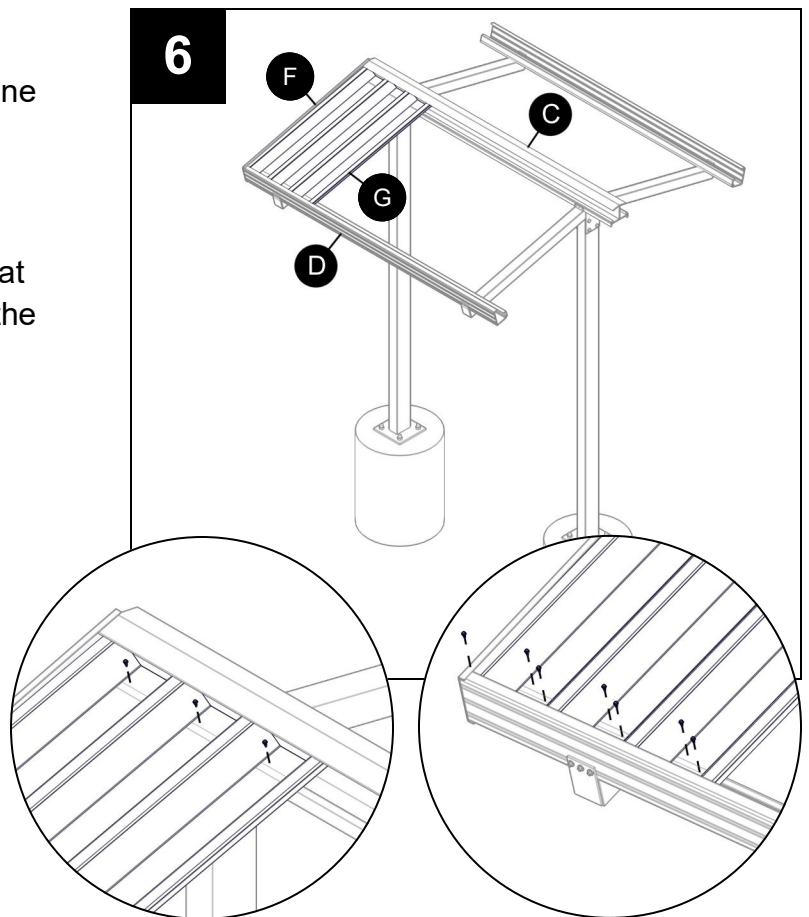

## STEP 7

Position the next roof panel (**G**) over the lock of the panel already installed and snap the locks together.

*HINT: Holding a spare board under the locks and tapping on top with a rubber mallet may help when joining roof panels.*

Fit the panel into ridge cap (**C**) and gutter (**D**) until the bottom end is flush with the previous panel. Attach the panel as shown in Step 6.

Repeat until all roof panels (**G**) are installed in one section of the roof.

*NOTE: To achieve best roof panel installation, it is very important to hold the 24" center-to-center spacing of the roof panel locks at the top and bottom of the panels.*

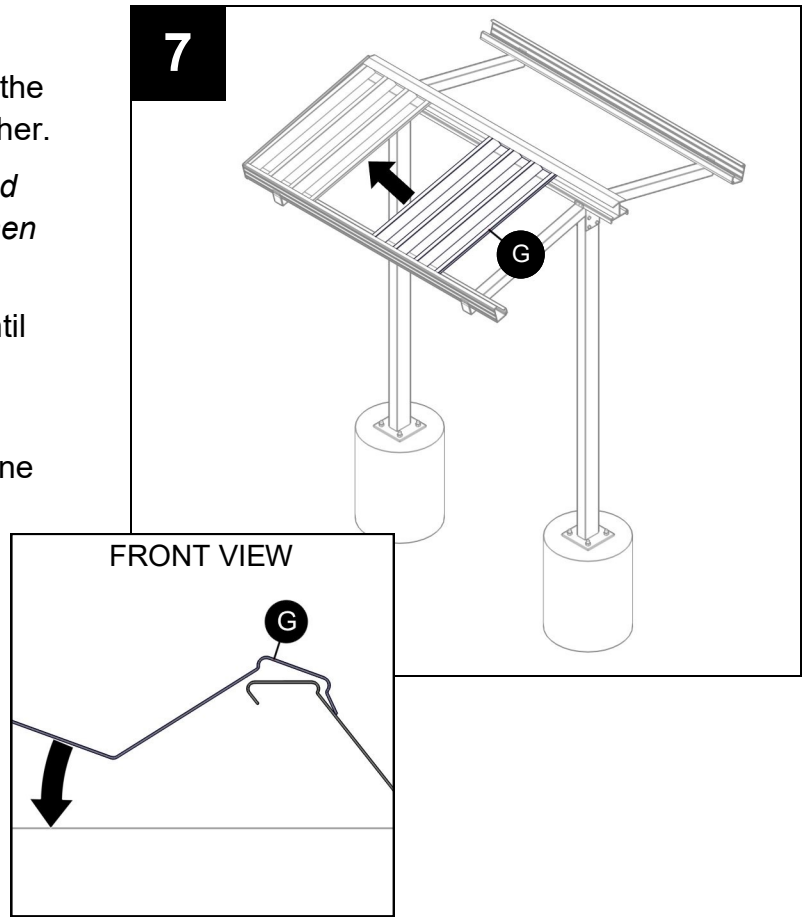

## STEP 8

Attach projection fascia (**F**) at the opposite end of the shelter as shown in Step 5.

Repeat Steps 5 - 8 to install remaining roof section.

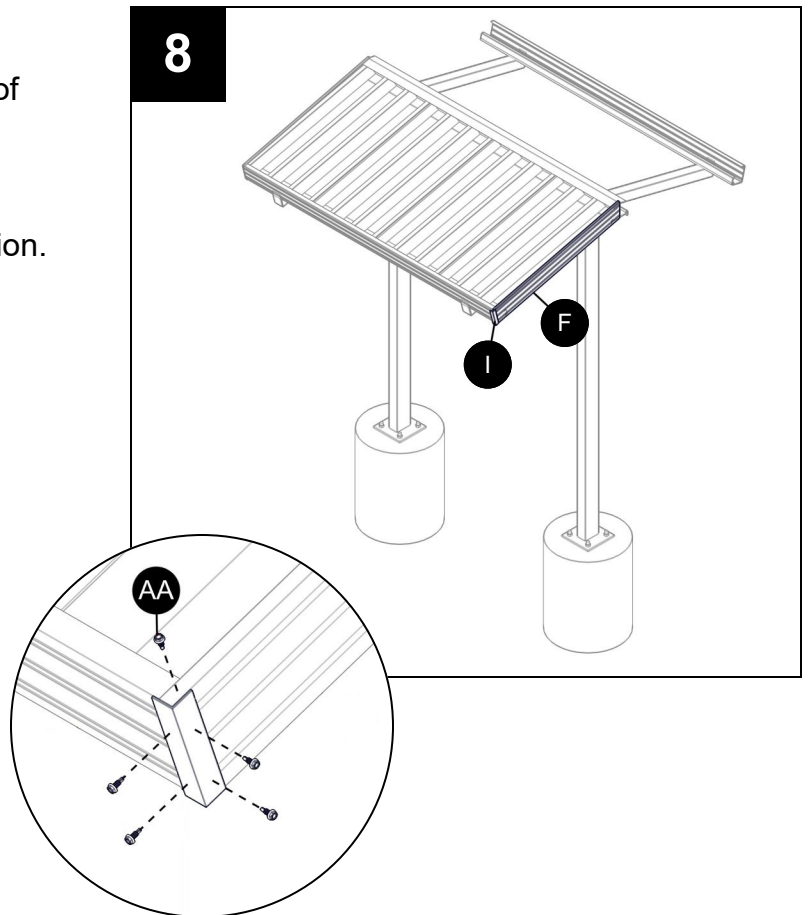

## STEP 9

Position peak cap (**J**) over projection fascias (**F**) at the peak of the structure. Attach using (4) #8 x 1/2" screws (**AA**).

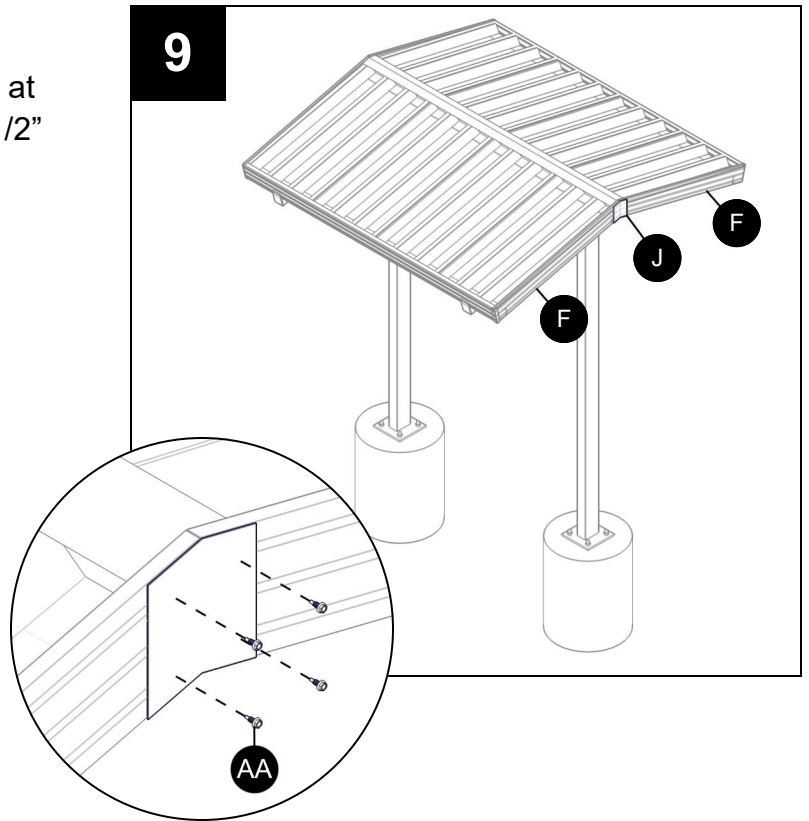

## STEP 10

*If optional downspout kit was received with your order, you may not have received scupper (**K**). Follow the separate downspout assembly instructions attached.*

Determine the desired location to drain water from gutter (**D**). Cut a hole no bigger than 2" diameter in the bottom of the gutter. Alternatively, drill several small holes in a rectangular pattern no bigger than 2" x 3".

Apply a generous bead of caulk around the top flange of scupper (**K**). Attach the scupper to gutter (**D**) using (2) #8 x 1/2" screws (**AA**).

Repeat for any remaining scuppers (**K**).

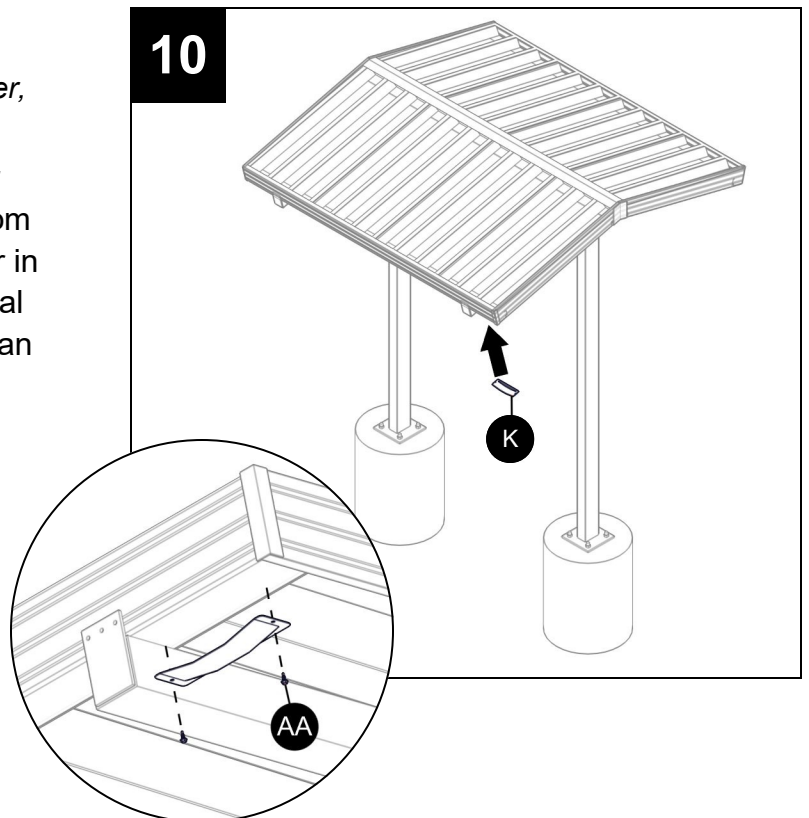

## ASSEMBLY COMPLETED

- Touch up paint has been supplied with the shelter to cover minor scratches or bolt and screw heads. Use a template to achieve a good finish and minimize over-spray.
- Be sure to sweep or brush all metal shavings off the shelter and leave the shelter in a clean condition to help prevent the rusting or staining of the surface finish.

## Warranty

### What the Warranty Covers:

The manufacturer warrants its products that have been installed in accordance with the installation guidelines, under normal usage conditions, and with proper maintenance as follows: Twenty-five (25) year limited warranty on steel against material failure and defects. Ten (10) year warranty against peeling, cracking, blistering, or crazing of the surface finish of aluminum and steel components. One (1) year warranty against defects in materials and workmanship.

### Period of Coverage:

The warranty period begins on the date of original shipment.

### What The Manufacturer Will Do To Correct Problems:

If defects or damage of the kind mentioned above should occur within the warranty period, the manufacturer will replace the defective parts only; upon receiving the written and documented claim of purchaser.

### What the Warranty Excludes:

Because of normal aging and weathering of materials, it may not be possible to perfectly match the colors of original parts and replacement parts. The manufacturer will not provide or pay for the installation of such replacement parts. The manufacturer shall not be responsible for weather related failures, damages due to faulty installation, misuse or abuse of the product, or for consequential damages, including personal injuries or property damages. There are no warranties, express or implied, which extend beyond the description on the face hereof.

### How Do You Get Service:

If you believe that you have a claim under this warranty, submit a copy of your original receipt or other reasonable evidence of the date of purchase, the identity of the product, and photos and a description of the allegedly defective product to the address below. Please also include your name, address, and phone number so that a customer service representative can respond to your submission. Ultimate determination of the existence and extent of any claimed defect under this warranty shall be made by the manufacturer in its sole discretion.

General Awnings LLC  
888-330-3115  
support@generalawnings.com